

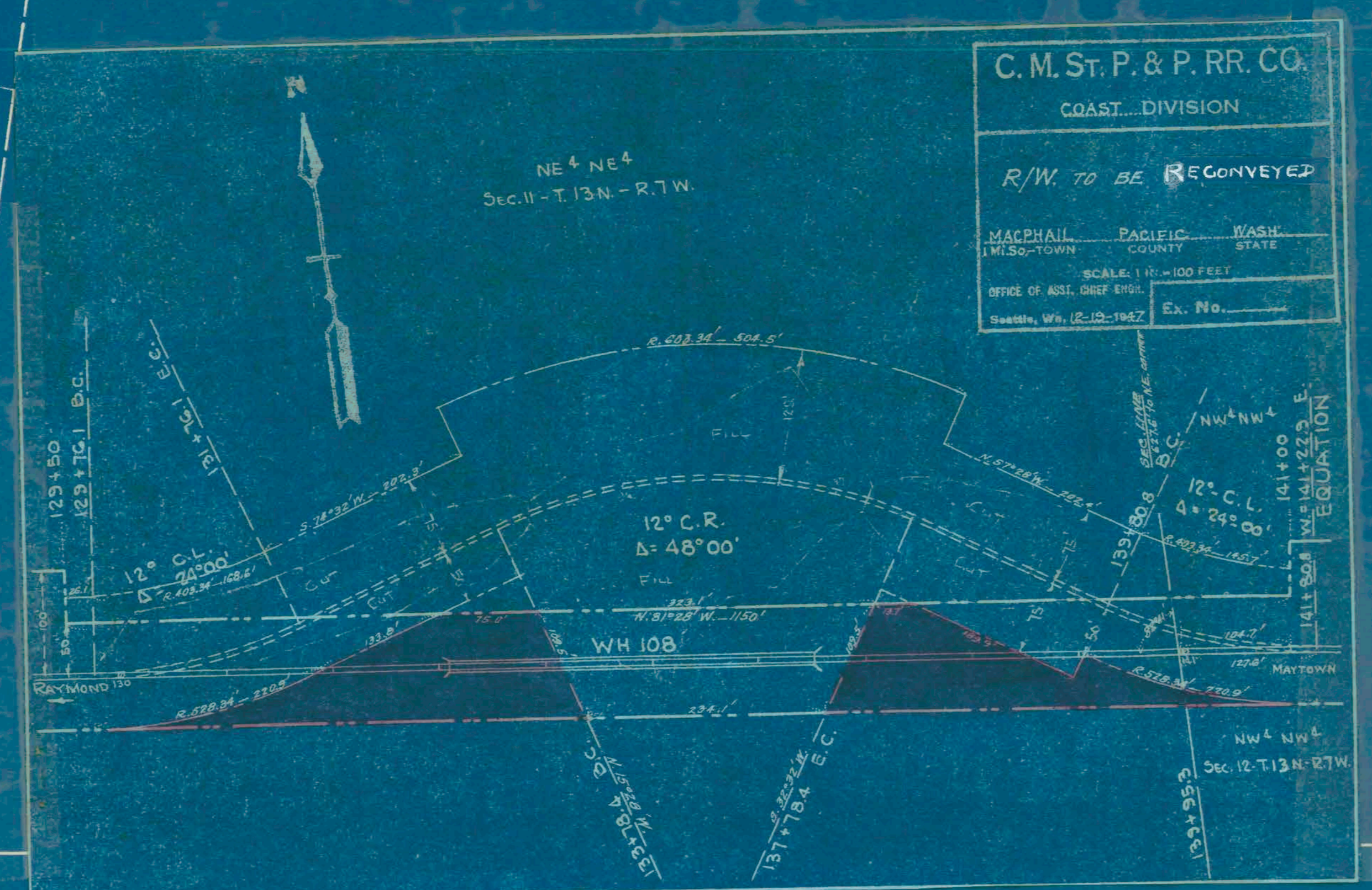

PARCEL NUMBER	OWNER	DEED	DATE	ACRES	REMARKS
1	Weyerhaeuser Timber Co.	PRM 1100	8-20-13	72.279, Oct. 15, 1913	9551
2	Willapa Lumber Co.	PRM 1100	8-20-13	72.279, Oct. 15, 1913	9552
3	Weyerhaeuser Timber Co.	PRM 1100	8-20-13	72.279, Oct. 15, 1913	9553
4	Sunset Timber Co.	PRM 1100	8-20-13	72.279, Oct. 15, 1913	9554
5	Willapa Lumber Co.	PRM 1100	8-20-13	72.279, Oct. 15, 1913	9555
6	Willapa Lumber Co.	PRM 1100	8-20-13	72.279, Oct. 15, 1913	9556
7	Willapa Lumber Co.	PRM 1100	8-20-13	72.279, Oct. 15, 1913	9557
8	Willapa Lumber Co.	PRM 1100	8-20-13	72.279, Oct. 15, 1913	9558
9	Willapa Lumber Co.	PRM 1100	8-20-13	72.279, Oct. 15, 1913	9559
10	Sunset Timber Co.	PRM 1100	8-20-13	72.279, Oct. 15, 1913	9560
11	Sunset Timber Co.	PRM 1100	8-20-13	72.279, Oct. 15, 1913	9561
12	Sunset Timber Co.	PRM 1100	8-20-13	72.279, Oct. 15, 1913	9562
13	Page Scale	PRM 1100	8-20-13	72.279, Oct. 15, 1913	9563
14	Weyerhaeuser Logged Off Land Co.	PRM 1100	8-20-13	72.279, Oct. 15, 1913	9564
15	Weyerhaeuser Timber Co.	PRM 1100	8-20-13	72.279, Oct. 15, 1913	9565

2 Phone Wires of Raymond Lbr. Co. on Rys Poles. Sutica to Willpa. R.N. 39. #. 4-18-32



RIGHT OF WAY AND TRACK MAP  
CHICAGO, MILWAUKEE & ST. PAUL RY. CO.

OPERATED BY THE  
CHICAGO, MILWAUKEE & ST. PAUL RY. CO.

COAST DIVISION MAYTOWN TO RAYMOND  
STATION 162+70.3 TO STATION 347+93.3

Sheet No. 14 of 17 sheets of C. M. & St. P. Ry. Co. Maytown-Raymond Line  
from survey station 162+70.3 to survey station 347+93.3

*A.E. Lodge*  
Valuation Engineer

SCALE 1 IN. = 400 FT. JUNE 30 1914  
OFFICE OF VALUATION ENGINEER  
CHICAGO, ILLINOIS

V. WASH. 20  
14

Pacific